

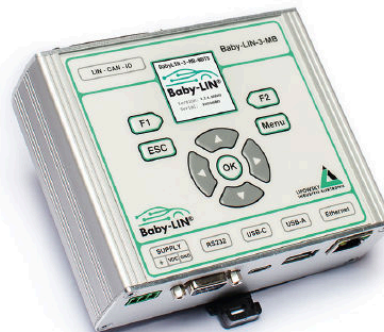

Baby-LIN-3-RC
Baby-LIN-3-RCplus



Baby-LIN-3-MB



Baby-LIN-3-Single
Baby-LIN-3-Dual



Baby-LIN-RM-III

Autostart

Application Note V1.2

Lipowsky Industrie-Elektronik GmbH

Römerstraße 57 | 64291 Darmstadt | Germany

Phone: +49 (0) 6151 / 93591 - 0

Website: www.lipowsky.com | E-Mail: info@lipowsky.de

1 Introduction	2
2 Section Properties	2
3 Device Section	2
4 Autostart Macro	2
5 Support information	4

1 Introduction

When a SDF is installed on the Baby-LIN to use it in Stand alone mode and start automatically, a three step setup has to be done on the SDF file in LinWorks SessionConf. After that the device will automatically start the selected macro when power is supplied.

This application note is not applicable for all devices.

2 Section Properties

Under the topic `Section properties` check the box "Store SDF in device persistently". The SDF will now be saved on the device and is not lost after a power cycle.

This property is shaded within all sections so it doesn't matter in which section you tick the checkbox.

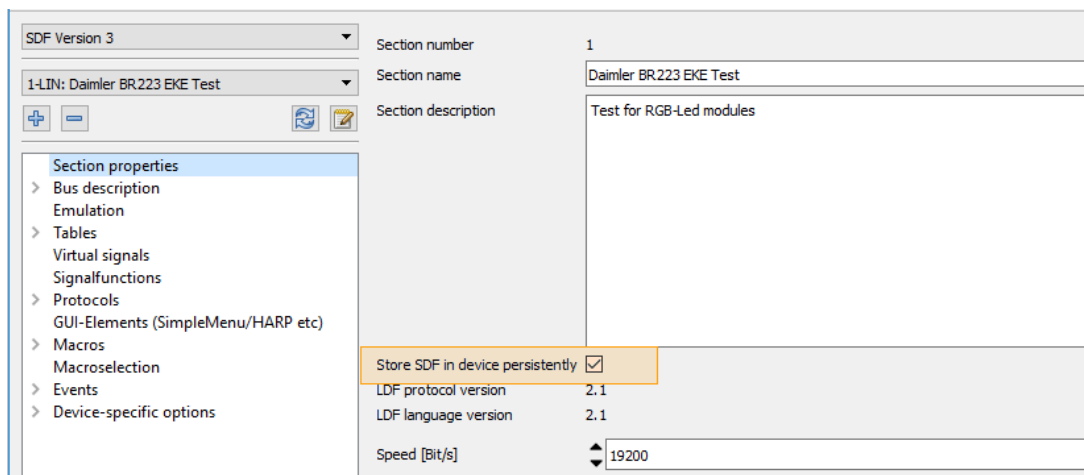

3 Device Section

Go to device section, section 0-DEV, and set 0: Autostart to "Load stored SDF and execute autostart macro if defined". We recommend to make these settings even if you do not use the Autostart feature.

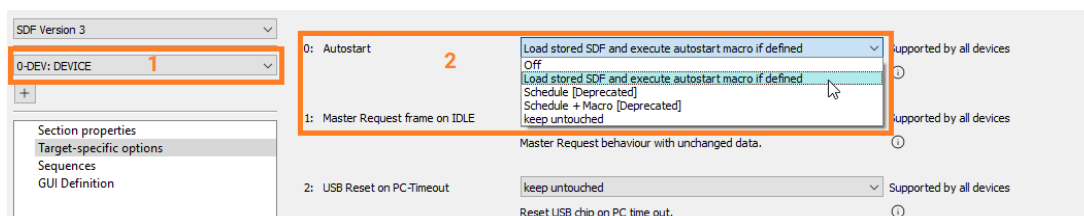

4 Autostart Macro

If you want to start a specific macro on Autostart, go back to the bus section and select the appropriate macro. To do so, right-click on macro in macro tree view and select "Toggle Autostart macro"

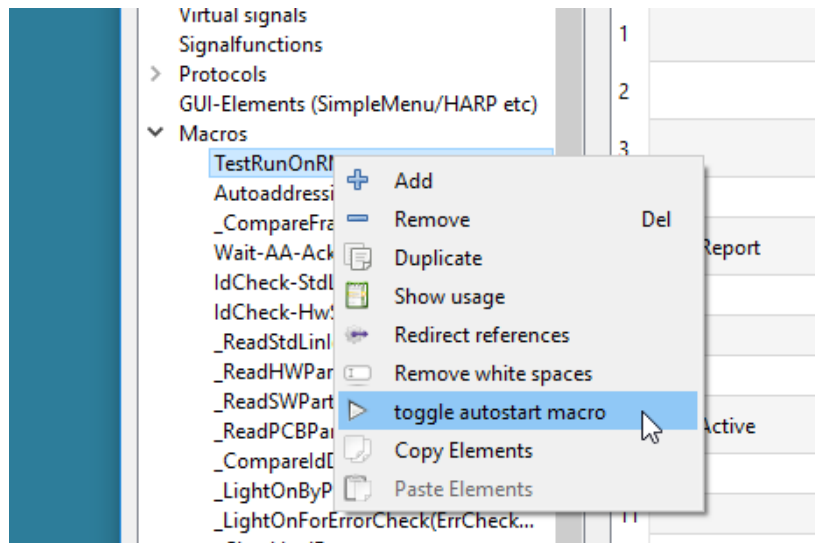

After this, the macro is marked with Autostart label.

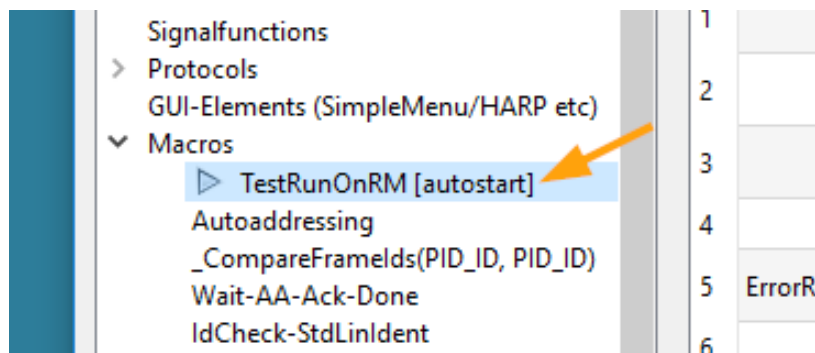

Then store the SDF as you are done. Loading the SDF to a device will automatically set the necessary target configuration parameters.

5 Support information

In case of any questions you can get technical support by email or phone. We can use TeamViewer to give you direct support and help on your own PC. This way we are able to sort out problems fast and direct. We have sample code and application notes available, which will help you to make your job.

Lipowsky Industrie-Elektronik GmbH realized many successful LIN and CAN related projects and therefor we can draw upon many years of experience in these fields. We also provide turn key solutions for specific applications like EOL (End of Line) testers or programming stations.

Lipowsky Industrie-Elektronik GmbH designs, produces and applies the Baby-LIN products, so you can always expect qualified and fast support.

Author	Lipowsky Industrie-Elektronik GmbH Römerstraße 57 64291 Darmstadt
Phone	+49 (0) 6151 / 93591 - 0
E-Mail	info@lipowsky.de
Website	www.lipowsky.com
CEO	Andreas Lipowsky
Commercial register	Darmstadt HRB 5139
VAT-ID	DE 111647423
Quality Management	DIN EN ISO 9001:2015